

## Robot to CB200 Series Pedestal Mounting



### Robot mounting hardware not provided.

Refer to your robot mounting specs for the recommended hardware.

Universal  
UR3, UR3e

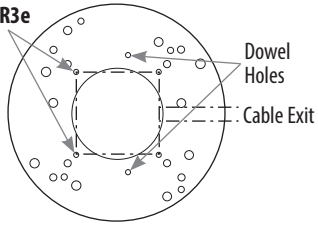

Cable Exit

Universal  
UR5, UR5e

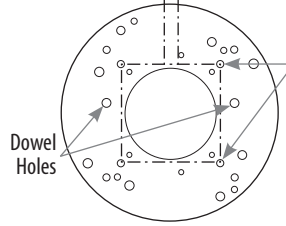

Dowel Holes

Cable Exit

Universal  
UR10, UR10e  
UR16, UR16e

FANUC  
CRX-10iA, CRX-10iA/L

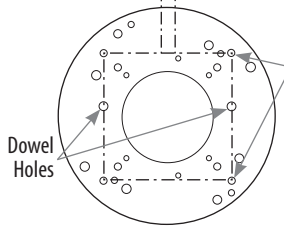

Dowel Holes

Cable Exit

Omron  
TM5

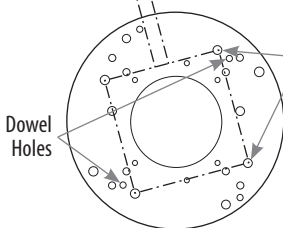

Dowel Holes

Omron  
TM12, TM15

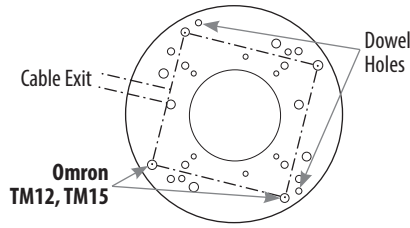

Dowel Holes

Hole configuration is same for pedestal and adapter mounting.

## RB-15ADAPTER-CB200 and RB-45ADAPTER-CB200 Installation

Kit includes: (2) mounting brackets, (1) mounting plate, (8) M8 bolts



### Robot mounting hardware not provided.

Refer to your robot mounting specs for the recommended hardware.

Use minimum of 50mm full-thread bolt with flat washer & lock nut.

1. Fasten the two mounting brackets to the robot pedestal with (4) M8 bolts each.
2. Lay the robot down on a flat surface. Fasten the adapter plate to the robot with the recommended robot mounting hardware. (Use minimum of 50mm bolt.)
3. **Utilize two people for steps 3 and 4.** Install the robot and adapter plate to the mounting brackets.
4. Align the bolts that are extending out the bottom of the mounting plate with the holes on the mounting brackets, then attach a flat washer and lock nut to each bolt. Tighten.
5. Make sure all nuts are tight before operating your robot.

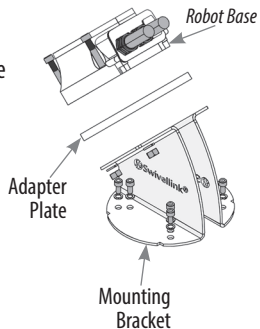

Formed edges of bracket face out.

www.swivellink.com

## Parts Feeder Assembly

1. Place RB-PFT-TMPHANG on pedestal and align with proper M8 mounting holes.
2. Place left and right adapter brackets (as shown) on TMPHANG, aligning the two outside holes of each bracket with holes on TMPHANG. Then start four M8 screws and washers (don't tighten).
3. Attach RB-PFT-MOUNT to adapter brackets with four M8 screws, M8 washers, M8 nuts and tighten. Then go back and tighten the 4 bolts that were left loose.
4. Attach RB-PFT-BASE to mount with four M8 screws, M8 washers, M8 nuts and tighten.
5. Insert three shoulder bushings into base and then fasten each one with two 5/16 screws and shims and nuts.
6. Push one pin clip near bottom groove of all three locator pins and then insert locators into shoulder bushings.
7. Insert another pin clip to each locator in for your desired template height. Then align template holes with locator pins and place on top of pin clips. (Add another set of pin clips on top of template for added template stability if needed.)
8. Attach brackets from RBPFT-CPBKT-KIT with two M6 screws and provided nuts per bracket. Then insert catch pan.
9. Your assembly process is complete. Use a dolly to move into position or two people lifting by pedestal top plate. Do not use template base to pickup.

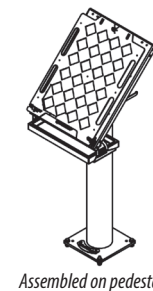
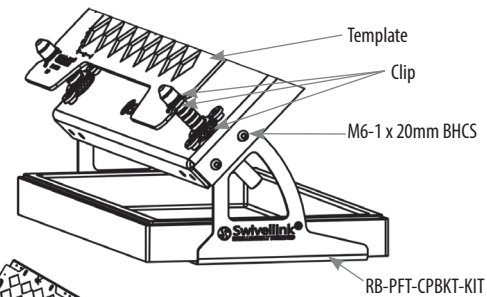
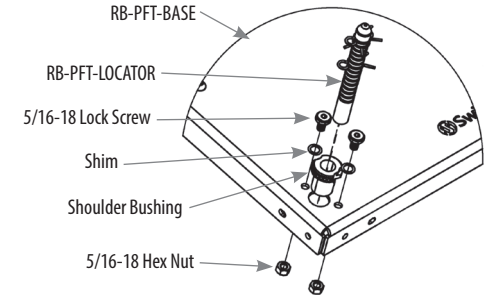
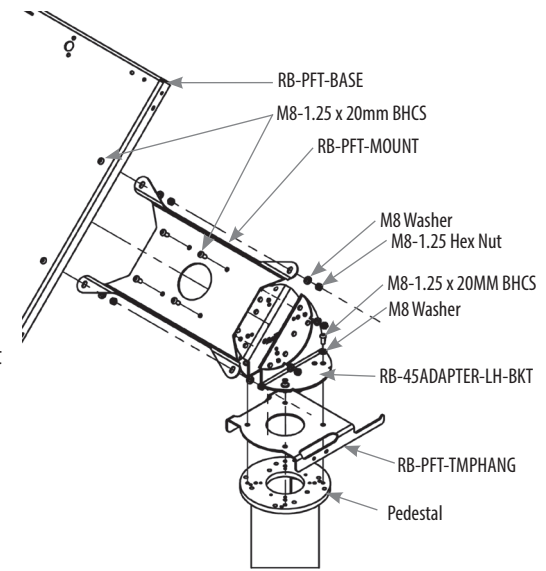

Assembled on pedestal

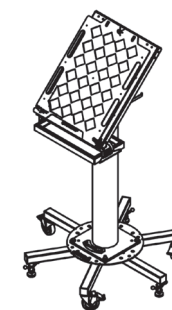

Assembled with optional RB-MB-COBOT mobile base

## RB-MB-COBOT Assembly

1. Remove jam nut from the leveling mount and add washer.
2. Fasten aluminum handle against the washer.
3. Fasten 1/2-13 jam nut tightly above the handle.
4. Add 1/2 flat washer.
5. Screw leveling mount assembly to pedestal where threaded inserts are located. Repeat for other 3 locations.
6. Insert a caster into one of the three remaining holes.
7. On the inside of the tube, add one 1/2 flat washer, 1/2 lock washer, 1/2-13 nut on the caster stud, then tighten and repeat for all three.
8. Add end caps to end of tubes.
9. Anchor RB-MB-ANCHOR (if applicable). Raise handle to clamp mobile base on anchor plate.

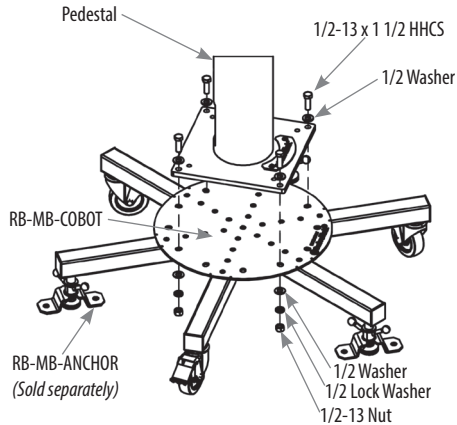
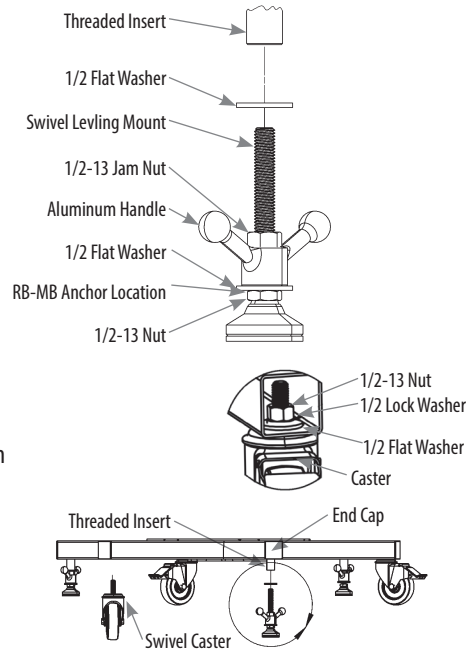

## CB200 Series pedestal to RB-MB-COBOT

1. Align four outside holes of the pedestal bottom plate with four holes on mobile base top plate. Additional holes allow for the pedestal to be bolted down in 15° increments.
2. Insert one 1/2-13 bolt and washer in each outside hole. If using a controller bracket, fasten with pedestal.
3. Start one 1/2 wash, 1/2 lock washer, and 1/2-13 nut to bottom of each bolt.
4. Tighten all four bolts down.

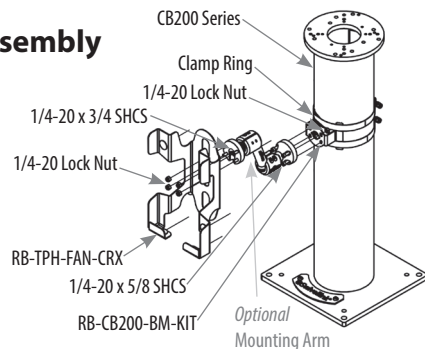

## Bracket Mount & Pendant Holder Assembly

1. Attach RB-CB-200-BM to pedestal with two clamp rings.
2. If using a mounting arm, assemble arm and bolt to bracket mount with four 1/4-20 x 3/4 screws and four 1/4-20 lock nuts as shown.
3. Attach pendant holder to ball base with four 1/4-20 x 3/4 screws and four 1/4-20 lock nuts.

## Controller Bracket Assembly

1. Assemble support legs to bracket.

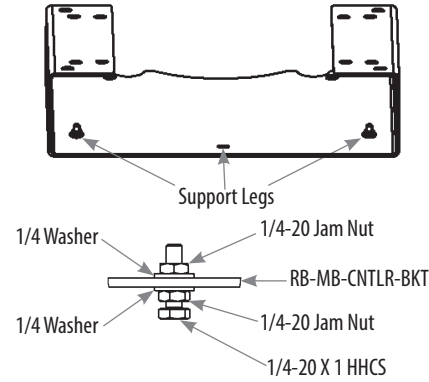

2. Assemble bracket to pedestal.

- *Floor mounting* - Utilize the anchors being used to mount pedestal.
- *Mobile base mounting* - Utilize the hardware being used to mount pedestal.

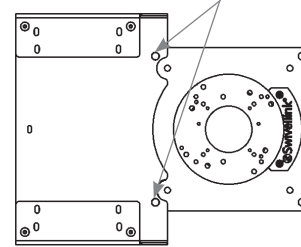

3. Locate hole location for controller.

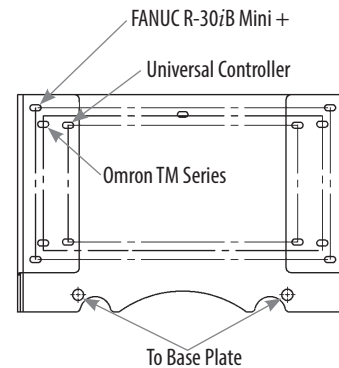

4. Assemble controller to bracket.

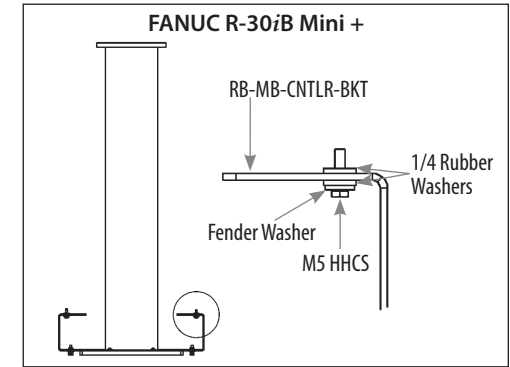

## Omron & Universal Controllers

